



SUPREME PETROCHEM LTD

INSUboard[®]

Extruded Polystyrene Thermal Insulation Boards

CFC & HCFC Free



Create
a refreshingly cool,
energy efficient
environment

Introduction

Supreme Petrochem Ltd is the largest producer of Polystyrene & Expandable Polystyrene beads in India, key raw materials for making Thermal Insulation Boards/Sheets. State-of-art manufacturing facilities are located in Nagothane, Maharashtra and Chennai, Tamilnadu.

Description

INSUboard – Extruded Polystyrene (XPS) Thermal Insulation Board is a rigid foam board having closed cell structure and is produced in a fully automated continuous extrusion process in accordance with international specifications and standards. Its unique properties of high compressive strength, higher R value and low water absorption makes it an ideal insulating material for roofs, walls and floors.

Key Features

- High resistance to heat flow, i.e. low thermal conductivity.
- High insulation value long term.
- Resistance to water vapour diffusion and water absorption.
- Long term durability.
- Uniform density distribution.
- Does not contain CFC/HCFC.
- High compressive strength, compared to other insulation materials.
- Light weight and easy to handle.
- Resistance to bacteria and micro organism growth.
- Non-toxic.
- Odourless and Non-irritant to skin.

The cost of energy and demand for air conditioning in buildings is constantly increasing. With increased energy conservation becoming more and more relevant, the ability of the product selected to effectively insulate a building of whatever type is very important.

Insulation should be viewed as a long term investment. Consequently, one of the best ways to optimize this investment is by choosing high quality and effective insulation material for buildings.

Properties

Heat Flow: **INSUboard** provides an excellent resistance to heat flow. There is no change in the K value (Thermal conductivity) of the material after prolonged usage and hence the heat flow into/out of the system remains intact.

Water Vapour: Closed cell structure of **INSUboard** provides exceptional resistance to water permeability and will absorb less than 1% water by volume.

Density: **INSUboard** has a uniformly high density and compressive strength, making it an ideal solution for over deck insulation and floor insulation in cold storages.

Fire: **INSUboard** is tested as per DIN 4102 and is available in both class B2 & B1.

Dimensional Stability: The regularity and homogeneity of **INSUboard** cellular composition ensures good dimensional stability.

Application: **INSUboard** is ideal for energy conservation in a wide range of industrial, commercial buildings, private dwellings, poultry sheds and in cold storages.

INSUboard is mainly used for thermal insulation of roofs, under deck insulation, external, internal and cavity wall insulation, EIFS, industrial and cold storage floors and underground constructions, and in marine applications.

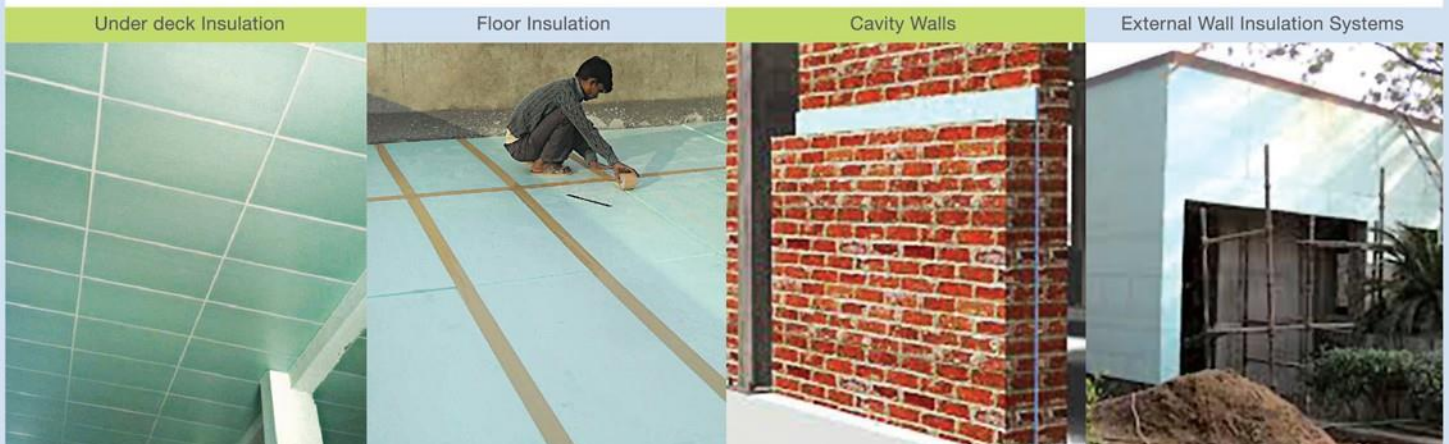

Technical Specifications

	DENSITY (Minimum)	COMPRESSIVE STRENGTH @ 10% DEFLECTION (Minimum)	FLEXURAL STRENGTH (Minimum)	WATER VAPOUR PERMEANCE OF 25.4MM THICK (Maximum)
Test Method	ASTM D-1622	ASTM D-1621	ASTM C-203	ASTM E-96*
Unit	kg/m3	kPa	kPa	ng/Pa.s.m2
SX40 Grade				
Thickness				
20mm - SX40202QWSX600X2400	40	180	345	NA
25mm - SX40252QWS600X1250	40	180	345	86
30mm - SX40302LWS600X1250	37	180	345	86
40mm - SX40402LWS600X1250	30	180	345	86
50mm - SX40502LWS600X1250	30	180	345	86
SX60 Grade				
Thickness				
25mm - SX60252QWS600X1250	47	300	414	63
30mm - SX60302LWS600X1250	41	300	414	63
40mm - SX60402LWS600X1250	38	300	414	63
50mm - SX60502LWS600X1250	36	300	414	63
75mm - SX60752LWS600X1250	34	300	414	63
100mm - SX61002LWS600X1250	34	300	414	63
SX70 Grade				
Thickness				
40mm - SX70402LWS600X1250	42	500	517	63
50mm - SX70502LWS600X1250	40	500	517	63
75mm - SX70752LWS600X1250	39	500	517	63
100mm - SX71002LWS600X1250	38	500	517	63
SX50 Grade				
Thickness				
50mm - SX50502LWS600X1250	47	700	690	63
75mm - SX50752LWS600X1250	43	700	690	63
100mm - SX51002LWS600X1250	39	700	690	63
Specifications (common to all grades)				
	Unit	Test Method	All Grades	
Thermal resistance of 25.4 mm thick XPS material at mean temperature of 24 ± 1 °C, Maximum	K.m2/W	ASTM C-518	0.88	
Equivalent Thermal Conductivity, Maximum*	W/m.K	ASTM C-518	0.0289	
Water Absorption by total Immersion, Maximum	Volume %	ASTM C-272	0.3	
Dimensional Stability (Changes in Dimensions), Maximum	%	ASTM D-2126	2	
Oxygen Index, Minimum*	% v/v	ASTM D-2863	24	
Edge Finish Flammability* Standard Size - Boards of all thicknesses Except 20mm Size of 20 mm		Ship Lap / Square Edge FR B2 DIN 4102 Part 1 600mm X 1250mm 600mm X 2400mm		

INSUboard meets the ASTM C 578 Board Type IV to Type VII as per customer requirements. Please check with SPL Marketing Representative for the same.

INSUboard is made from CFC/HCFC Free Blowing Agents.

For parameters with (*) mark, the product is "TYPE TESTED" once in six months in BIS / MoEF / DGS&D / DDCA approved laboratory.

Above specifications are for our "STANDARD product".

INSUboard with lower thermal conductivity, higher compressive strength for load bearing floor insulation of cold storages, higher density or B1 fire rating are available, on specific requests. Please contact SPL Marketing Representative for the same.

Application Guide: Customers are advised to use appropriate Building Codes and Regulations applicable in their region before using **INSUboard**. Supreme Petrochem Ltd assumes no liability, whether expressed or implied, of the intended application.

INSUtile Ready to use lightweight roof insulation tiles are also available upon request.

Disclaimer: Data presented in this specification sheet are typical values and are intended to serve as guide only. SPL reserves the right to review and alter the contents of this specification sheet without prior notice.

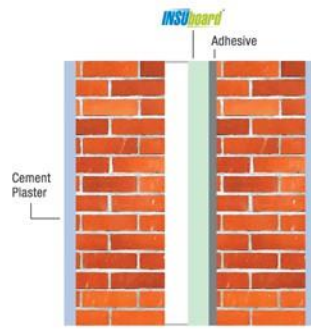
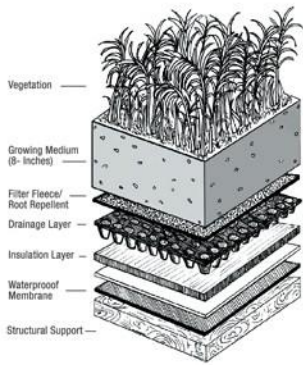

CAVITY WALL INSULATION

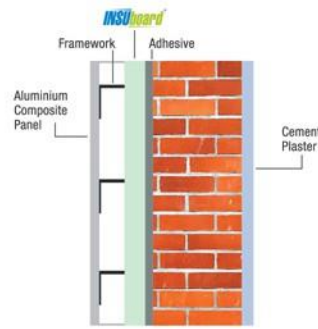

WALL INSULATION BEHIND ALUMINIUM COMPOSITE PANEL

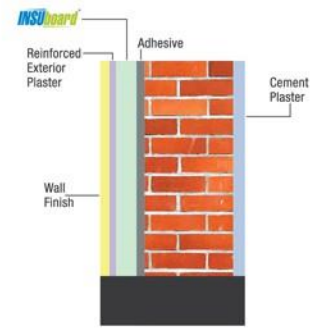

EXTERIOR WALL INSULATION

Storage

INSUboard should be stored on a flat surface and in covered areas - away from direct sunlight and ultraviolet rays.

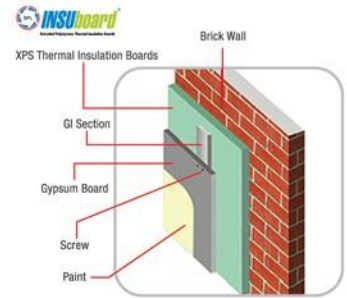
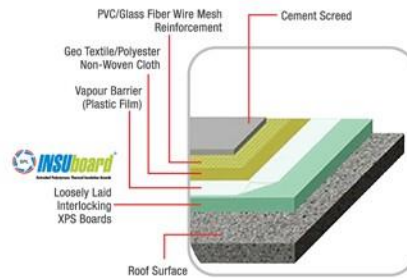

Corporate Office & Zonal Office (West)

Name: Mr. Sanjay Shimpi
Supreme Petrochem Ltd.
Solitaire Corporate Park, Building No. 11,
5th Floor, 167, Guru Hargovindji Marg,
Andheri - Ghatkopar Link Road,
Chakala, Andheri (E), Mumbai - 400 093,
Maharashtra, India.
Contact no.: +91 98200 86072
Email: sg_shimpi@spl.co.in

Zonal Office (North)

Name: Mr. Rakesh Kumar Jha
Supreme Petrochem Ltd.
Unit No. 10th Floor, WTT Tower B,
Plot No. C - 1, Sector - 16,
Noida - 201 301
Contact no.: +91 98100 41436
Email: rk_jha@spl.co.in

Zonal Office (South)

Name: Mr. B. S. Jayaram
Supreme Petrochem Ltd.
39 - I, North Parade Road, Chakrapani Colony,
St. Thomas Mount, Chennai - 600 016
Contact no.: +91 98453 17454
Email: bs_jayaram@spl.co.in

Zonal Office (East)

Name: Mr. Aritra Goswami
Supreme Petrochem Ltd.
183, Rajdanga, Block BF II, 1st Floor,
Shantipally, Kolkata - 700 107
Contact no.: +91 98049 99538
Email: aritra_goswami@spl.co.in

Exclusion of Liability

The information contained herein is provided for general reference purpose only. By providing the information contained herein, Supreme Petrochem Ltd makes no guaranty or warranty, and does not assume any liability, with respect to the accuracy or completeness of such information, or the product results in any specific instance and hereby expressly disclaims any implied warranties of merchantability or fitness for a particular purpose, or any other warranties or representations whatsoever, expressed or implied. Nothing contained herein shall be construed as a license to use the products of Supreme Petrochem Ltd in any manner that would infringe any patent.



SUPREME PETROCHEM LTD

This October 2020 revision supersedes all previous editions.

Email : insuboard@spl.co.in,
xps_marketing@spl.co.in

Website : www.supremepetrochem.com,
www.insuboard.com

